

Robt. Gilmore

No. 3319.

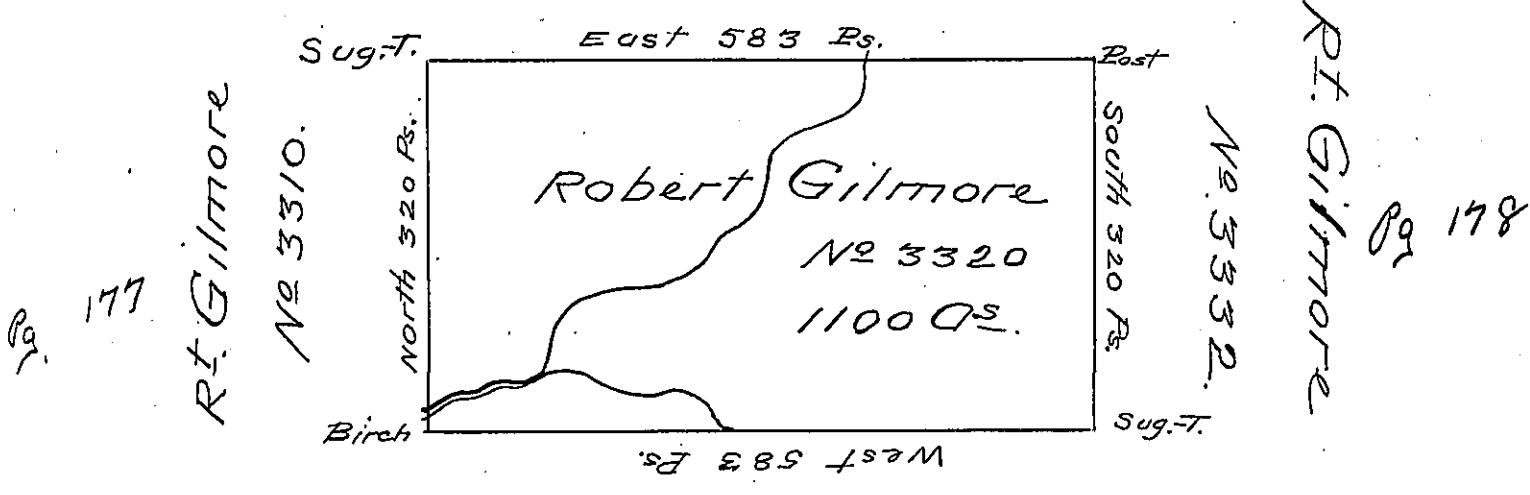

No 3321.

Rt. Gilmore

SITUATE on the East Side of the Middle Branch of Ischunungwandt Creek six miles South of the State Line in the last Purchase District No 4 Surveyed June the twenty ninth 1793 in Pursuance of a Warrant to Robert Gilmore No 3320 Dated the fourteenth day of December 1792 for 1000 acres Containing Eleven hundred acres and the usual allowance of six PE Ct for Roads

PE James Hunter D.S.

To Daniel Brodhead Esq^r S. G.

June 29th.

IN TESTIMONY that the above is a copy of the original remaining on file in the Department of Internal Affairs of Pennsylvania, made conformably to an Act of Assembly approved the 16th day of February, 1833, I have hereunto set my Hand and caused the Seal of said Department to be affixed at Harrisburg, this Twenty sixth day of October 1904.

Isaac R. Brown
 Secretary of Internal Affairs.